

# Add Dahua Device via P2P into the DMSS APP

---

## Description

---

This article will cover how to add a Dahua device to DMSS via P2P

## Prerequisites

---

- Admin password for your Dahua Device
- Serial number for your device
- Stable internet connection
- [DMSS](#) Mobile App Installed

# Step by Step Instructions

---

1. Ensure your device is online and connected to the internet.
2. Once the DMSS Mobile App is installed please create a DMSS account by clicking “Log in” and then the “Sign Up” buttons. Note, if you already have created an account please log in using your existing details and skip to step 4.

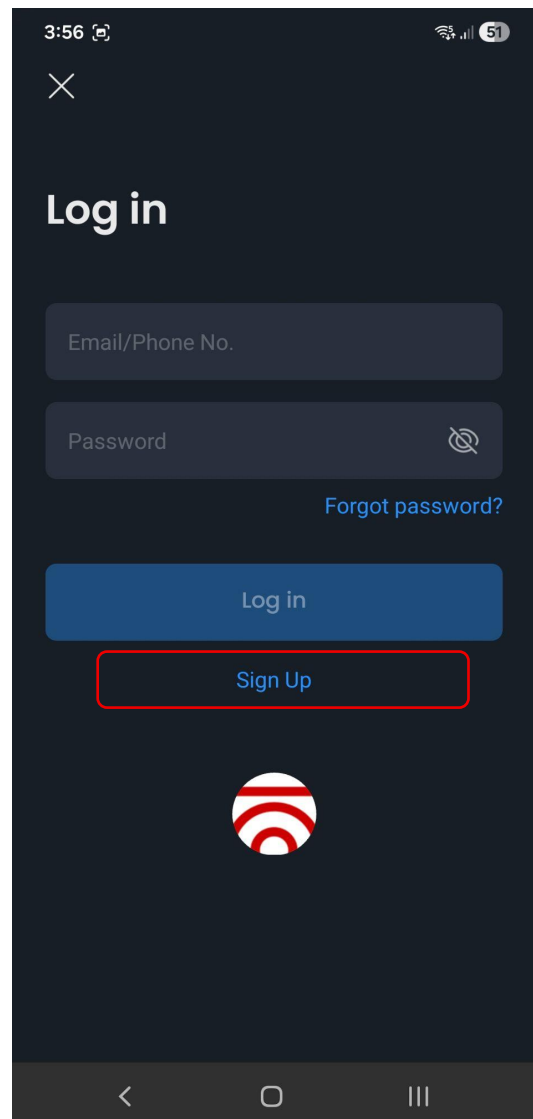
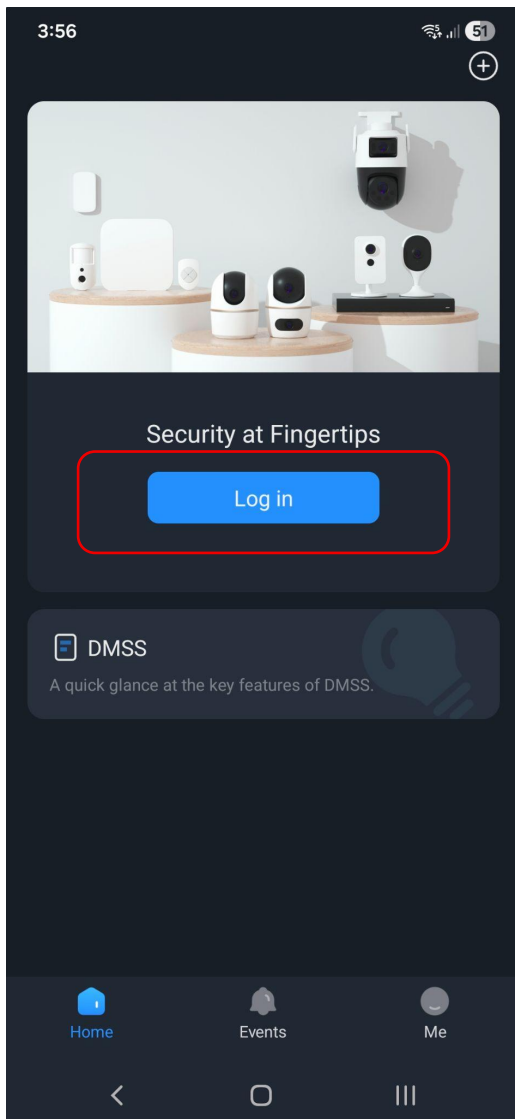

3. In the sign up page; enter your phone number or email address and a password of your choosing. Accept the privacy agreement and press “get verification code”. Complete the captcha by selecting the prompted images and you will receive a verification code from DoLynk cloud via text or email. Enter this verification code to verify your details are correct:

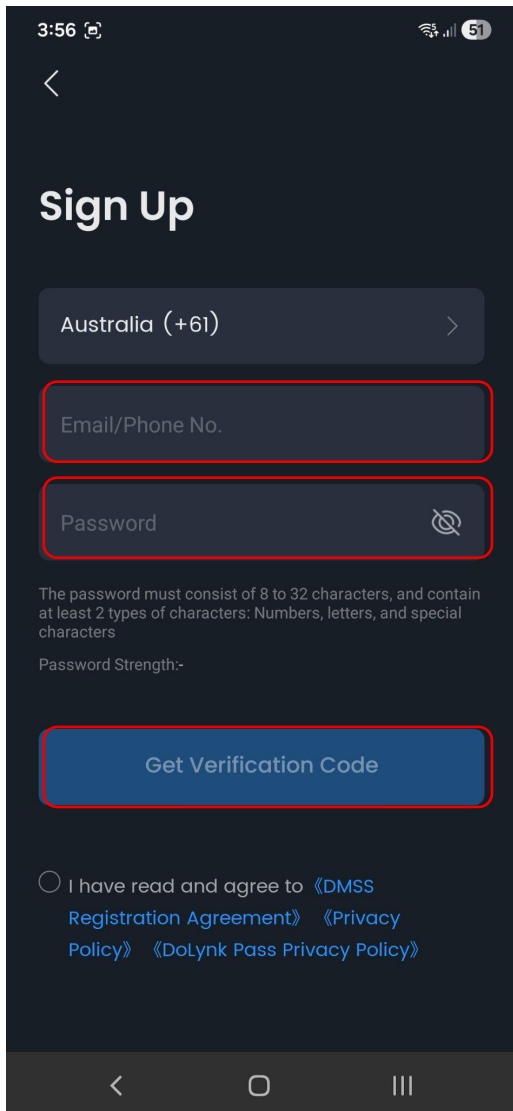

3:56

<

## Sign Up

Australia (+61) >

Email/Phone No.

Password 

The password must consist of 8 to 32 characters, and contain at least 2 types of characters: Numbers, letters, and special characters

Password Strength:-

Get Verification Code

☐ I have read and agree to [《DMSS Registration Agreement》](#) [《Privacy Policy》](#) [《DoLynk Pass Privacy Policy》](#)

< ○ |||

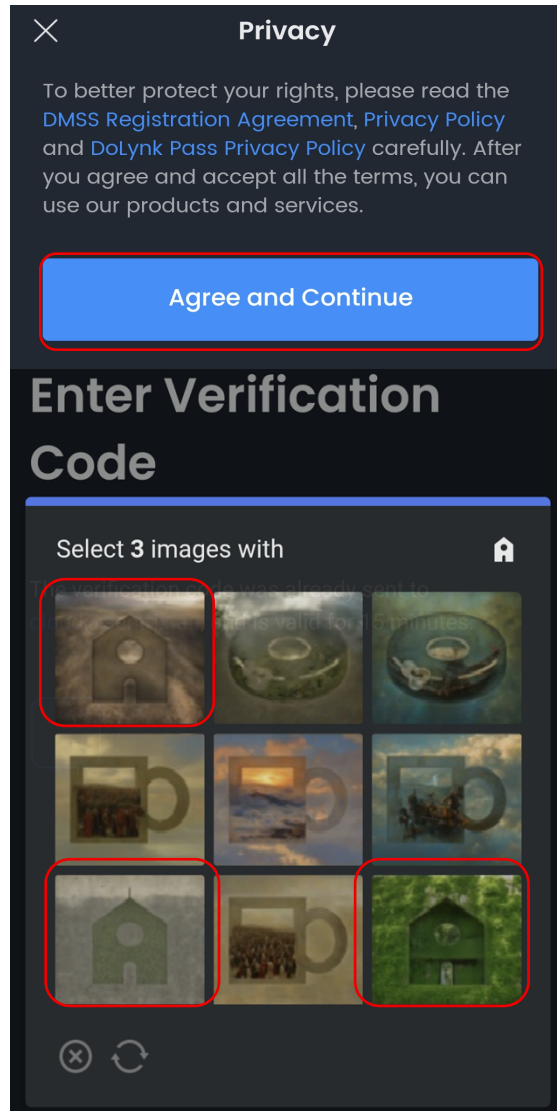

✕ Privacy

To better protect your rights, please read the [DMSS Registration Agreement](#), [Privacy Policy](#) and [DoLynk Pass Privacy Policy](#) carefully. After you agree and accept all the terms, you can use our products and services.

Agree and Continue

## Enter Verification Code

Select 3 images with 

The verification code was already sent to [xxxx@xxxx](#), and is valid for 15 minutes.



⊗ ↺

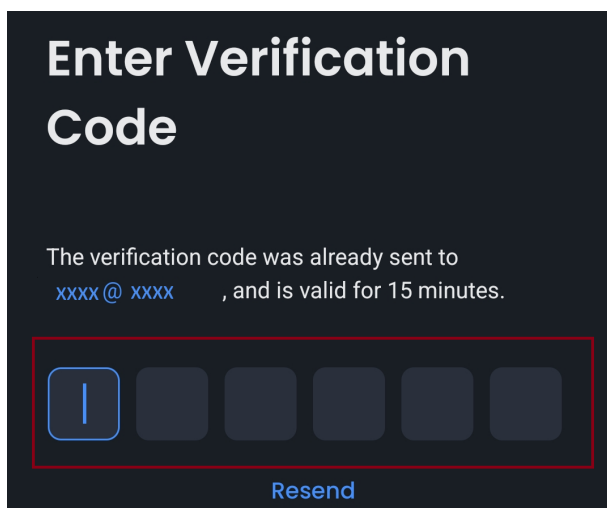

## Enter Verification Code

The verification code was already sent to [xxxx@xxxx](#), and is valid for 15 minutes.

Resend

4. Once signed in; In the DMSS mobile app, navigate to the Home tab (bottom left) and tap the + in the top right corner, or the Add Device button if available:

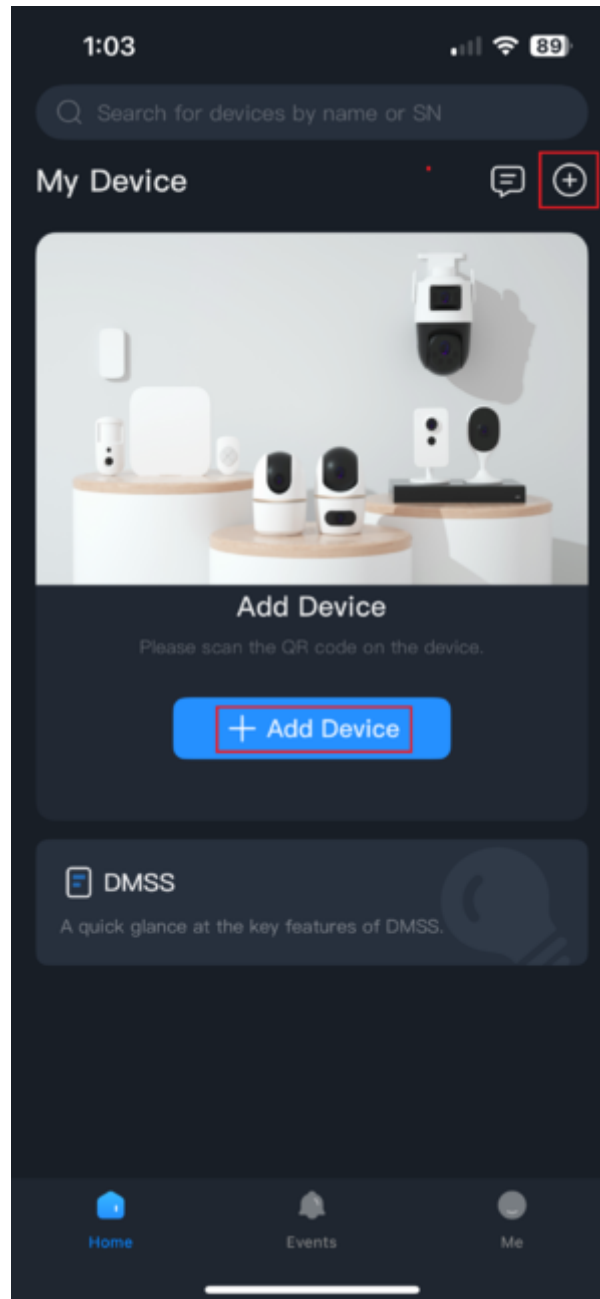

5. Select the QR Code option:

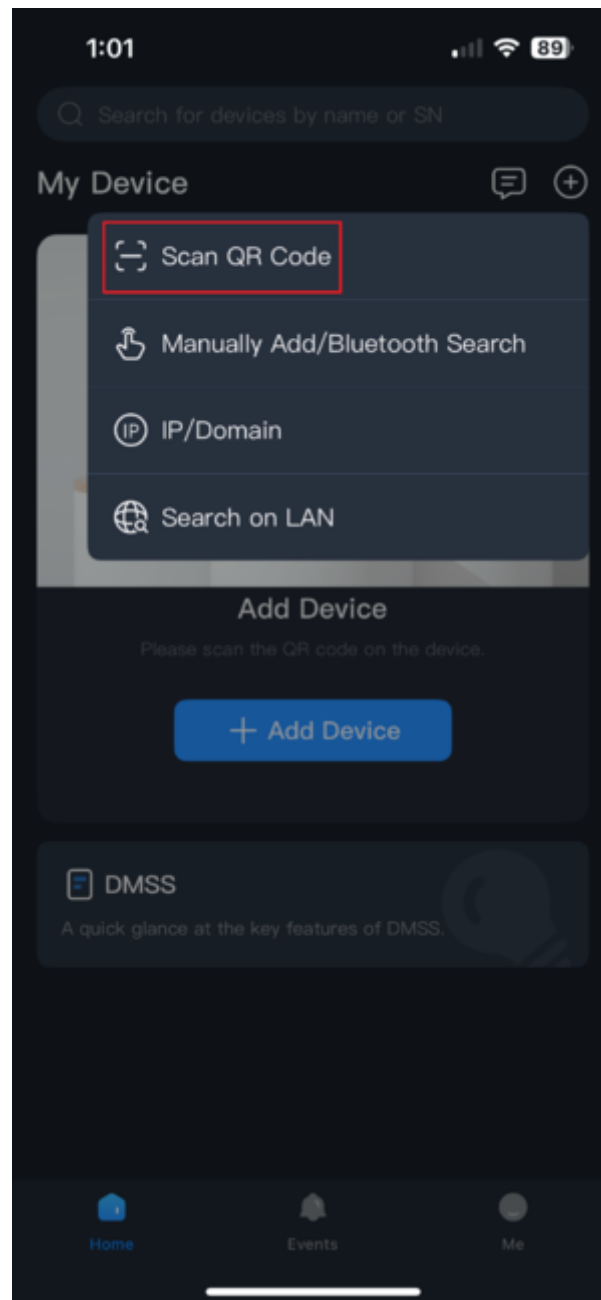

6. If prompted, be sure to allow DMSS to access your devices camera:

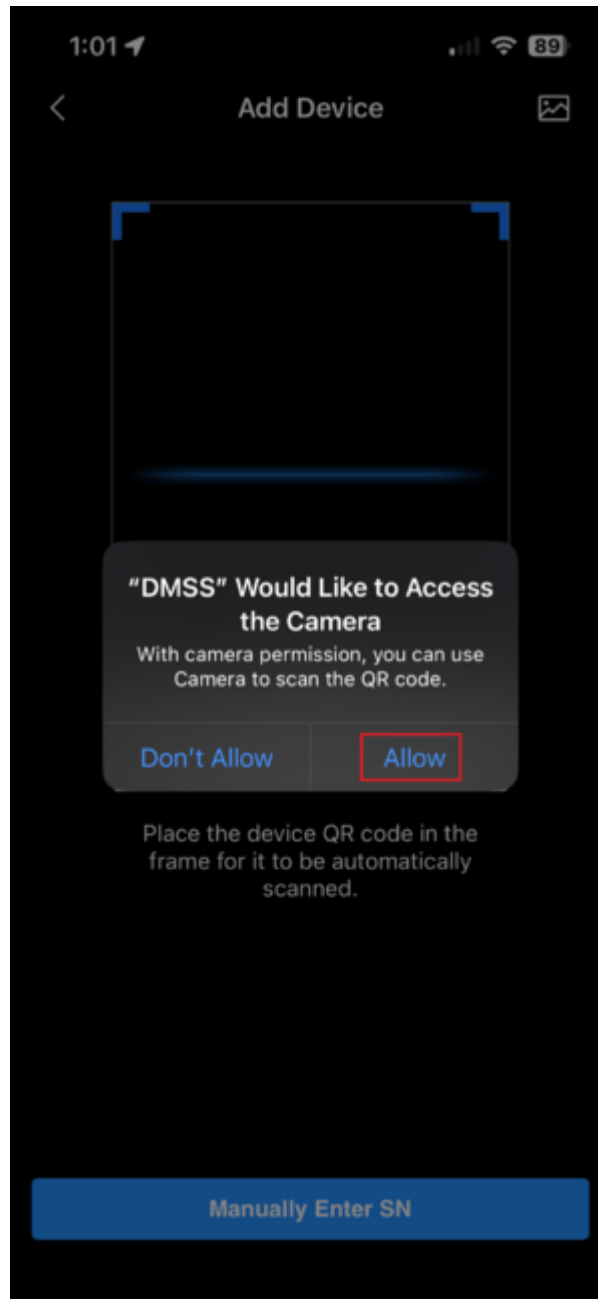

7. If you have the QR Code, place it in the frame of the scanner. Alternatively, you can select the option to Manually Enter :

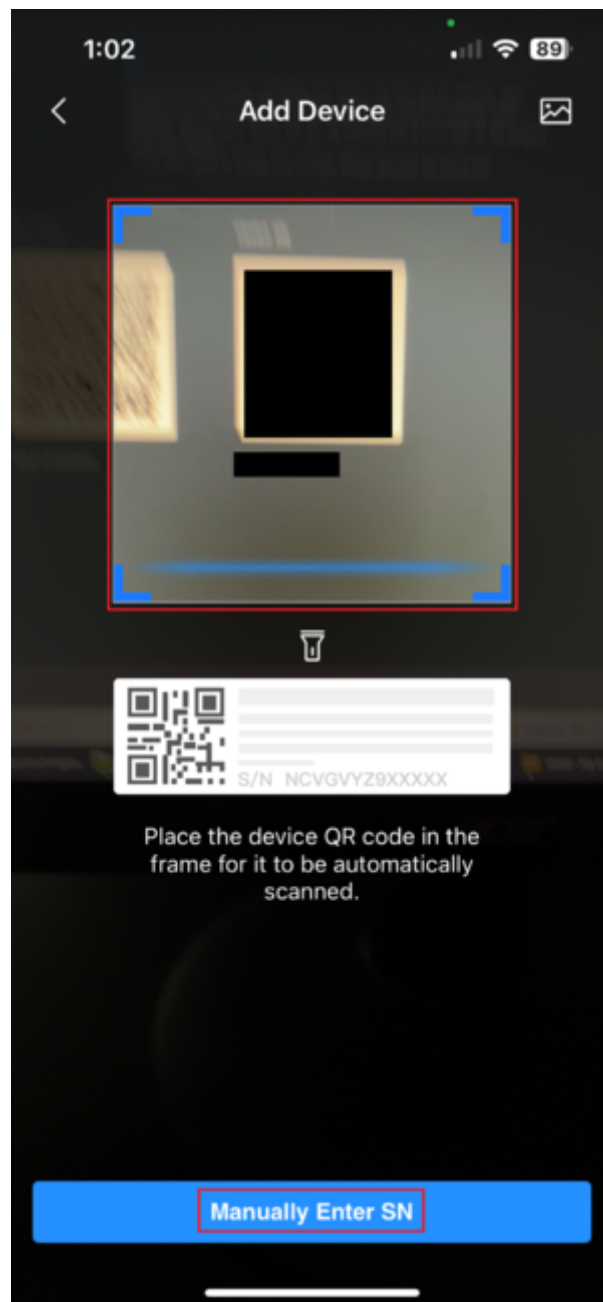

8. After the scan completes it will auto-fill the serial number for you (or you will type it in here if you chose to manually enter). Do not enter a security code. Press Next:

1:02 89

< Add Device

S/N XXXXXXXXXXXXXXXX

Device SN and Security Code

8

~~Please enter the security code~~

If the security code is not on the device label, you can leave this field empty.

Next

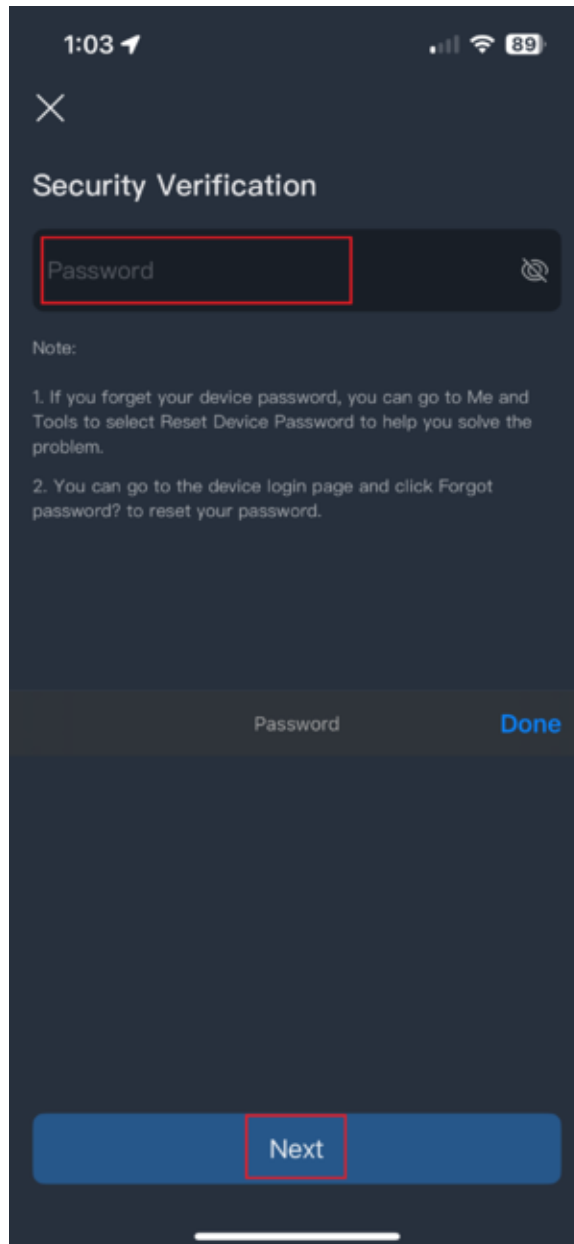

9. Enter your device's admin password and press Next. Note: This is not your DMSS account password, it is the **admin** password for the device you are adding. For Android users, you may be prompted to select your device type before entering the Name and password for **admin**.

A screenshot of a mobile application's 'Security Verification' screen. The screen has a dark blue background. At the top, there is a status bar showing the time '1:03', signal strength, Wi-Fi, and battery level '89'. Below the status bar is a close button (X). The title 'Security Verification' is centered. Below the title is a password input field with the placeholder text 'Password' and a red border. To the right of the input field is a small icon of a crossed-out circle. Below the input field is a 'Note:' section with two numbered instructions. At the bottom of the screen is a large blue button with the text 'Next' in white. The word 'Password' is also visible in a smaller font above the 'Next' button.

1:03

Security Verification

Password

Note:

1. If you forget your device password, you can go to Me and Tools to select Reset Device Password to help you solve the problem.
2. You can go to the device login page and click Forgot password? to reset your password.

Password

Done

Next

10. The app will take a moment to authenticate the request:

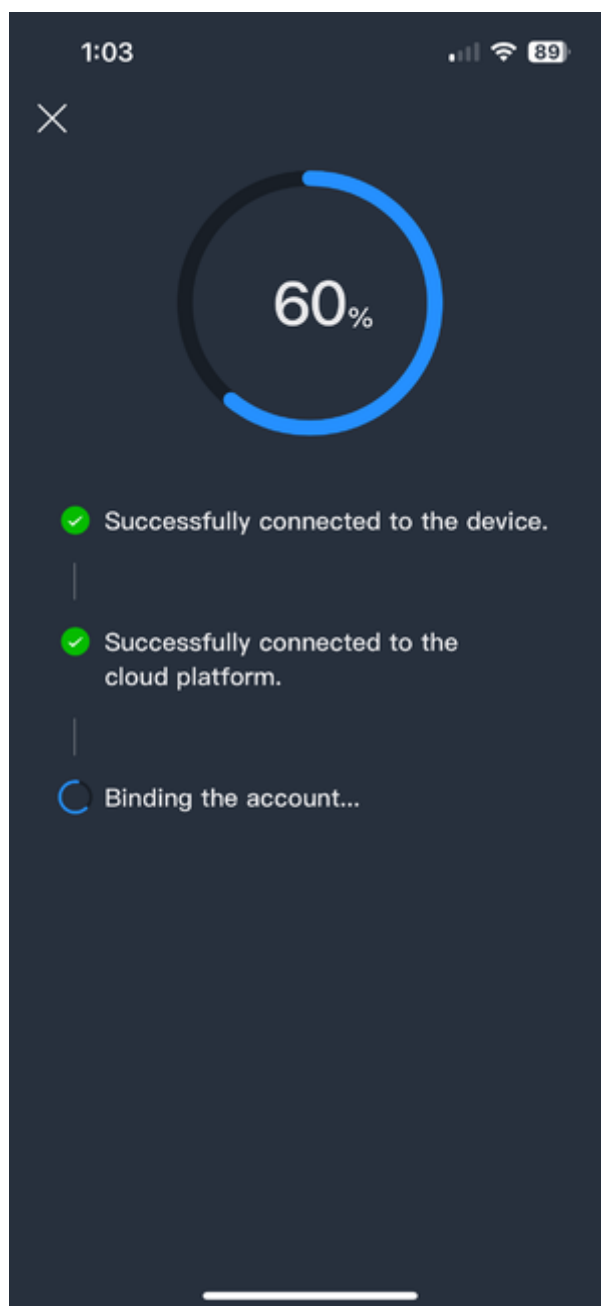

11. After verifying, you will be asked to name the device so you can identify it in your device list, as well as set your time zone and DST settings. Once completed, press Get Started.

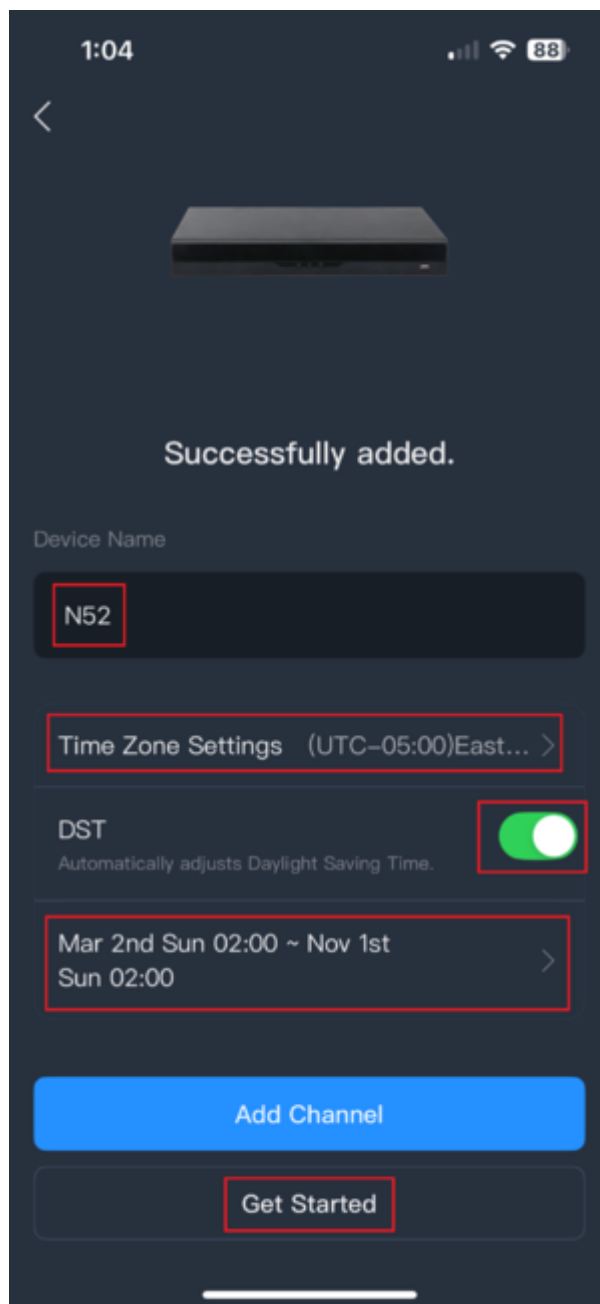

1:04

<

Successfully added.

Device Name

N52

Time Zone Settings (UTC-05:00)East... >

DST

Automatically adjusts Daylight Saving Time.

Mar 2nd Sun 02:00 ~ Nov 1st Sun 02:00 >

Add Channel

Get Started

12. Once completed, you will be redirected to the Home tab and your newly added device will be displayed.

