

# VTO2111D-WP(433)

## 1MP Wi-Fi Villa Outdoor Station



### Features

- HD CMOS camera
- Large field of view angle
- Night vision
- Voice indication
- Remote intercom with mobile APP
- Airfly technology
- Surface mounted



### Technical Specification

Mode	DHI-VTO2111D-WP(433)
------	----------------------

#### System

Main Processor	Embedded Micro Processor
Operation System	Embedded LINUX OS

#### Video

Video Compression	H.264
Image Sensor	1/4" 1MP CMOS
Lens	2.2mm
Angle of View	D:125° H:105°
Day/Night	ICR

#### Audio

Audio Compression	G.711
Audio Input	Omnidirectional Mic
Audio Output	Built-in Speaker
Bidirectional Talk	Support Dual-way Bidirectional talk

#### Operation Mode

Keypad	Single Mechanical Button
Reader	Mifare Card
Body Approaching	1m

#### Interface

Door Control	2(1 relay out for main lock, 1 extended by access control module)
Alarm In	2(1ch unlock button, 1ch feedback)
RS485	1

#### Network

Wi-Fi	IEEE802.11b/g/n
-------	-----------------

Ethernet	10M/100Mbps Self-adaptive
Network Protocol	TCP/IP

#### General

Ingress Protection	IP65
Tamper Switch	1
Wireless Frequency	433MHz
Memory Slot	Micro SD, Max 32G
Installation	Surface
Material	Plastic
Power	DC 12V,PoE(802.3af)
Power Consumption	Standby ≤1W, Work ≤10W
Working Environments	-30°C~+60°C
Relative Humidity	10%~90%RH
Dimensions	135mm×70.4mm×34.4mm
Weight	0.4Kg

## Dimensions

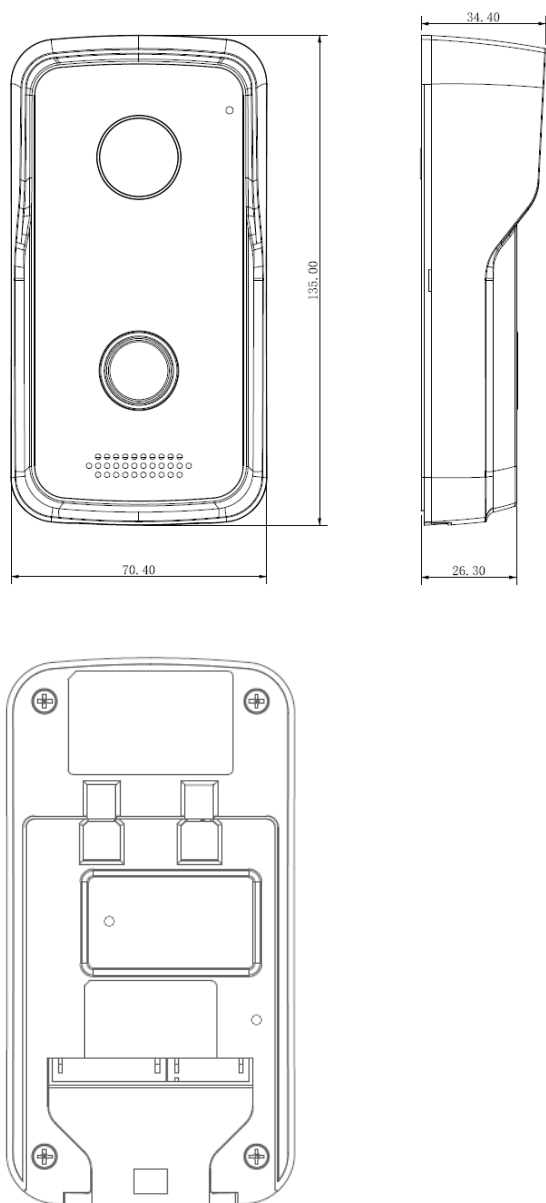

## Application

### 1 – Smart Doorbell

Call Mobile phone APP directly without indoor monitor

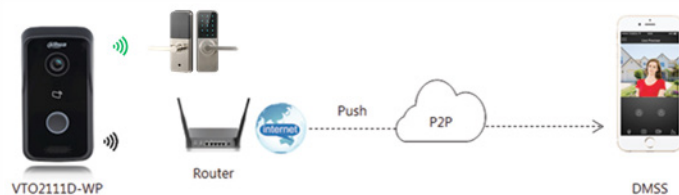

### 2 – Video Intercom

- Color video & audio call
- IPC surveillance
- Alarm integration
- Remote intercom with mobile APP

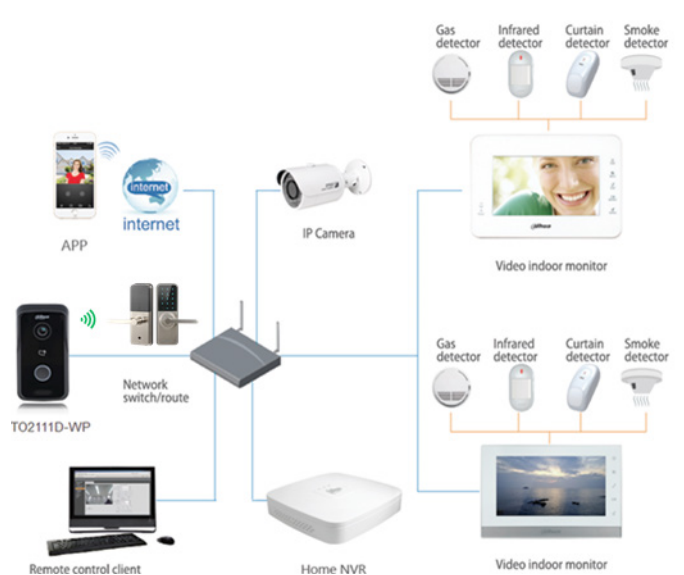

# VTH5221D/DW

## Wi-Fi Indoor Monitor



### Features

- 7" TFT Capacitive touch screen, 1024x600
- IPC surveillance
- Alarm integration
- Micro SD card optional, max 32GB
- Record & Snapshot(SD card needed)



### Technical Specification

Model	VTH5221D/DW
-------	-------------

#### System

Main Processor	Embedded Micro Processor
Operation System	Embedded LINUX OS

#### Video

Video Compression	H.264
-------------------	-------

#### Audio

Audio Compression	G.711
Audio Input	All-direction Microphone
Audio Output	Built-in Loudspeaker
Bidirectional Talk	Support Dual-way Bidirectional talk

#### Display

LCD Screen	7" 1024x600, Capacitive
------------	-------------------------

#### Operation Mode

Input	Touch buttons
-------	---------------

#### Interface

Alarm In	6
Alarm Out	1
RS485	1

#### Network

Wi-Fi	IEEE802.11b/g
Ethernet	10M/100Mbps Self-adaptive
Network Protocol	TCP/IP

#### General

Memory Slot	Micro SD, Max 32GB
-------------	--------------------

Installation	Surface
Power	DC 12V, PoE (802.3af)
Power Consumption	Standby ≤1W, Work ≤7W
Working Temperature	-10°C~+55°C
Relative Humidity	10%~90%RH
Dimensions	215.0mm×140.0mm×21.0mm
Weight	0.8Kg

## Dimensions

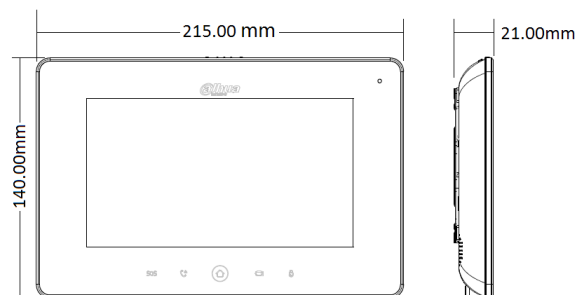

## View Area

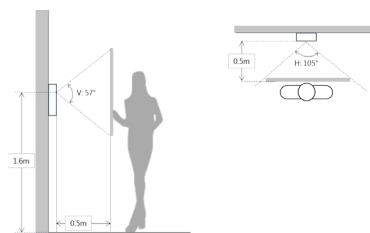

## Application

